



BUREAU OF FIRE SAFETY

EAST BRUNSWICK FIRE DISTRICTS #1 & #3
680 OLD BRIDGE TURNPIKE
EAST BRUNSWICK, N.J. 08816
TEL: (732) 651-8806
FAX: (732) 257-0960

Requirements for a Certificate of Smoke Alarm, Carbon Monoxide Alarm and Portable Fire Extinguisher Compliance are as follows:

SMOKE ALARMS See diagram for placement

10 YEAR SEALED BATTERY smoke alarms shall be installed and shall be listed in accordance with ANSI/UL 217. **HOWEVER** A/C powered smoke alarms installed as part of the original construction or rehabilitation project **SHALL NOT** be replaced with battery powered smoke alarms. Smoke alarms shall be installed as follows:

- *On each level of the premises
- *Outside each sleeping area
- *Within 10 feet of all bedrooms

Smoke alarms mounted on the ceiling should be a minimum of 4 inches from a wall. Smoke alarms mounted a wall should be no closer than 4 inches to the ceiling, and no more than 12 inches from the ceiling.

CARBON MONOXIDE ALARMS See diagram for placement

Carbon Monoxide Alarms shall be installed in all dwelling units that contain a fuel-burning appliance (gas dryer, gas water heater, oil or gas heating appliance, wood burning fireplace) and/or an attached garage. CO Alarms shall be installed as follows:

- *Carbon Monoxide alarms shall be installed within 10 feet of all bedrooms
- *Carbon Monoxide Alarms may be battery-operated, hard-wired or of the plug-in type and shall be listed in accordance with UL-2034

PORTABLE FIRE EXTINGUISHER

A portable fire extinguisher shall be installed as follows:

- *The extinguisher shall be an approved, listed and labeled type with a minimum rating of **2A-10BC** and no more than 10 pounds.
- *The extinguisher shall be in the kitchen or within 10 feet of the kitchen
- *The extinguisher shall be mounted using the manufacturer's hanging bracket
- *The extinguisher shall be mounted no higher than 5 feet off the floor

HOUSE NUMBERS

Numbers on house must be at least 4 inches in height, clearly visible from the street and be of contrasting colors of the surrounding colors. Numbers on a curbside mailbox must be on both sides and be at least 2 inches in height.

SMOKE DETECTORS SAVE LIVES!

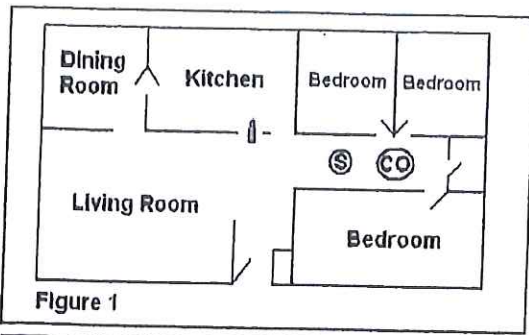

Figure 1

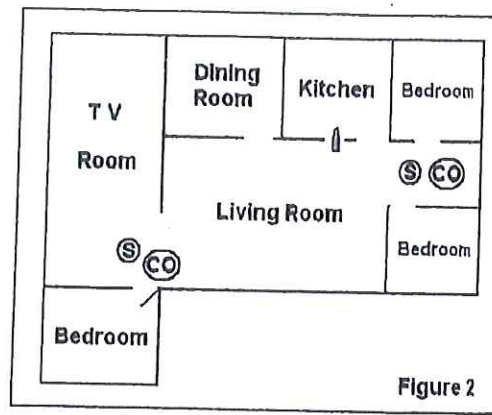

Figure 2

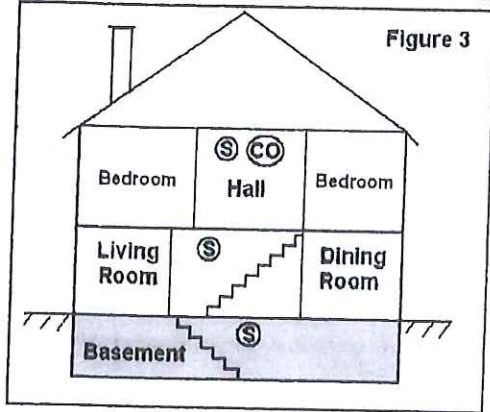

Figure 3

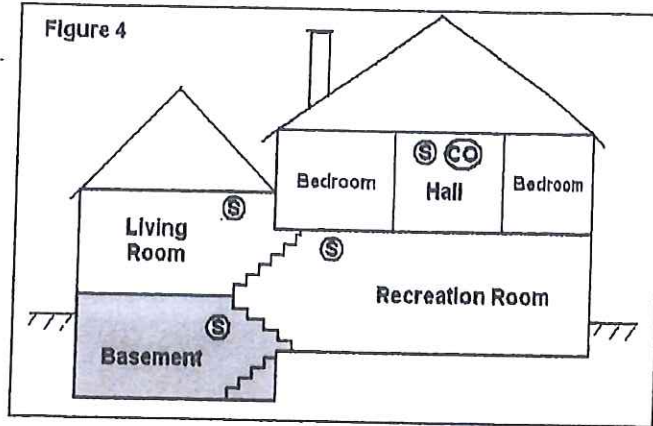

Figure 4

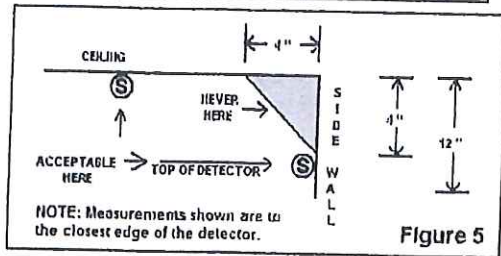
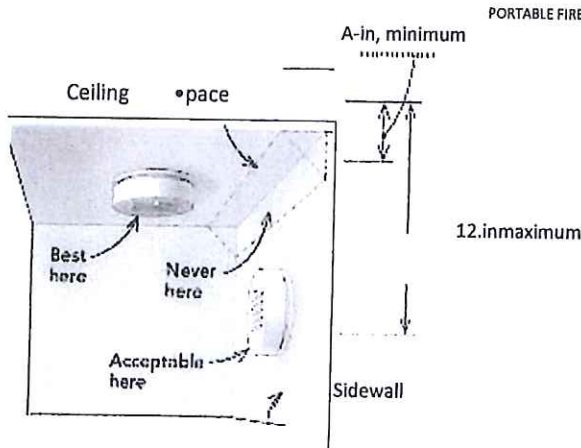

Figure 5

🔥 PORTABLE FIRE EXTINGUISHER

Ⓢ SMOKE DETECTOR ⓐⓐ CARBON MONOXIDE ALARM

SIWFR06-1-001



PORTABLE FIRE EXTINGUISHER

ATTIC SMOKE AND CARBON MONOXIDE ALARMS NOT REQUIRED OR RECOMMENDED	
SECOND STORY ONE SMOKE ALARM REQUIRED IF NO BEDROOMS SMOKE ALARM REQUIRED IN EACH BEDROOM AND REQUIRED NEAR BEDROOMS CARBON MONOXIDE ALARM REQUIRED NEAR BEDROOMS AND IN BEDROOMS WITH FUEL-BURNING APPLIANCES	
FIRST STORY ONE SMOKE ALARM REQUIRED IF NO BEDROOMS SMOKE ALARM REQUIRED IN EACH BEDROOM AND REQUIRED NEAR BEDROOMS CARBON MONOXIDE ALARM REQUIRED NEAR BEDROOMS AND IN BEDROOMS WITH FUEL-BURNING APPLIANCES	
SUCKE AND CARBON MONOXIDE ALARMS	CRAWL SPACE SMOKE AND CARBON MONOXIDE ALARMS *URNS NOT REQUIRED

Alarm Location Requirements in Two Story Home